

# FLIGHT 93 NATIONAL MEMORIAL

"A common field one day ... A field of honor forever"

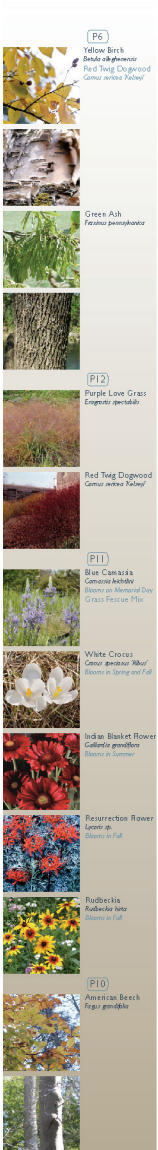

SPRING  
MEMORIAL DAY



A white stone slab on the Flight Path provides entry for families to the Sacred Ground. Offset concrete walls frame a gate, opened only for ceremonies or family visits. The western wall holds a folded band of polished, translucent white marble with the forty names inscribed in alphabetical order and the date of September 11, 2001. This marble band is backlit at night from within the wall. A cluster of American Beech trees at the walls and bench provides shade and shelter and are uplighted to foster intimacy and indirect illumination of the area. As at the Portal, the Flight Path is illuminated with recessed in-grade linear bias lines of gentle light perpendicular to the path. The fence line is changed to include the existing earth mound within the Sacred Ground for family seating and contemplation. The Hemlock Grove and cabins are preserved to provide solitude and shelter to family visitors.

## SACRED GROUND



SACRED GROUND WALLS WITH INSCRIBED NAMES

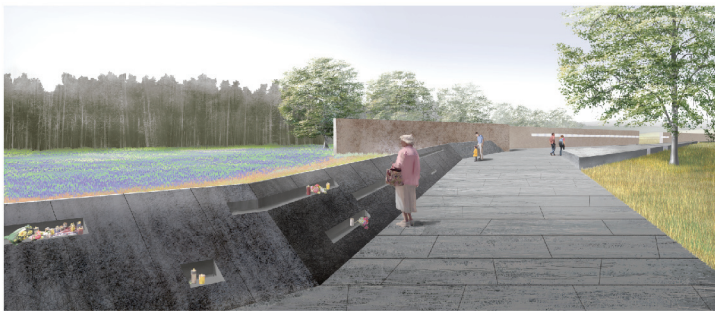

SACRED GROUND PLAZA



SACRED GROUND SECTION  
4 FT. 16 FT. 48 FT.

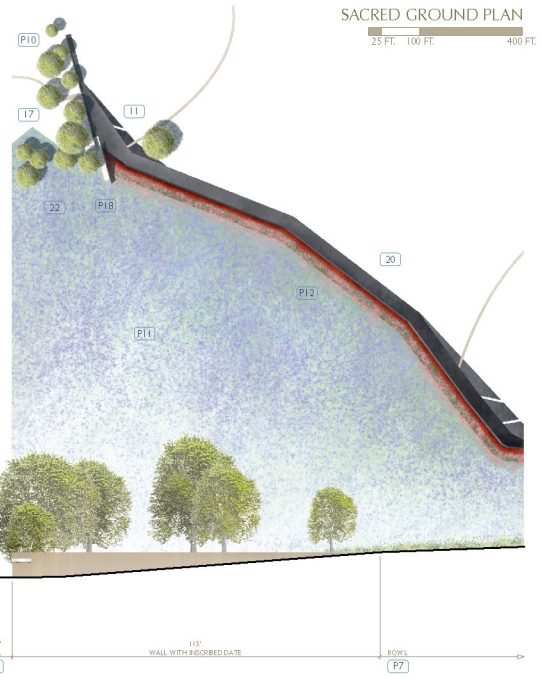

SACRED GROUND PLAN